

Atal Awaz Yojna

LAYOUT APPROVAL

PROPOSED LAYOUT PLAN OF ATAL AWAZ SCHEME
 AT PART OF KH. NO. 3786 KH. 3786/3, P.H. NO. 60,
 VILLAGE ARANG, TA. ARANG & DIST. RAIPUR (C.G.)

TOTAL LAND AREA	12.310 HECTARE
	30.41 ACRES
AREA FOR FUTURE EXPANSION	OF 123100.00 SQM
NET PLANNING AREA	14888.11 SQM
ATL AWAZ YOJNA	108231.89 SQM

S.NO	PARTICULARS	AREA IN SQM	PER.
1	RESIDENTIAL AREA	53777.65	49.69
2	COMMERCIAL AREA	2228.76	2.06
3	OPEN AREA	11330.46	10.47
4	ROAD AREA	40895.02	37.88
	TOTAL	108231.89	100.00

NO OF PLOTS	PLOT SIZE IN METER		AREA IN SQM
	L	B	
835	10.60	4.85	48068.35
		TOTAL	48068.35



APPROVED
 3 Years
 Valid up to 3 Years

Subject to the conditions
 in the plan No. 3786/3-2008

Signature
 Assistant Engineer
 C.G. Housing Board,
 Raipur, Dist. Raipur

S.NO.	REVISIONS	DATE
1	Enlarged in 1:1500	27-05-2008
2	AS PER YOJNA	14-04-2008

CHK. BY	DHRUV
DATE	DRN. BY
14.06.2007	1:1500
	SCALE

SUB ENGINEER
 SHEETAL DEWAGAN
 P. ARCH. M.C.A.
 CHHATTISGARH HOUSING BOARD
 RAIPUR

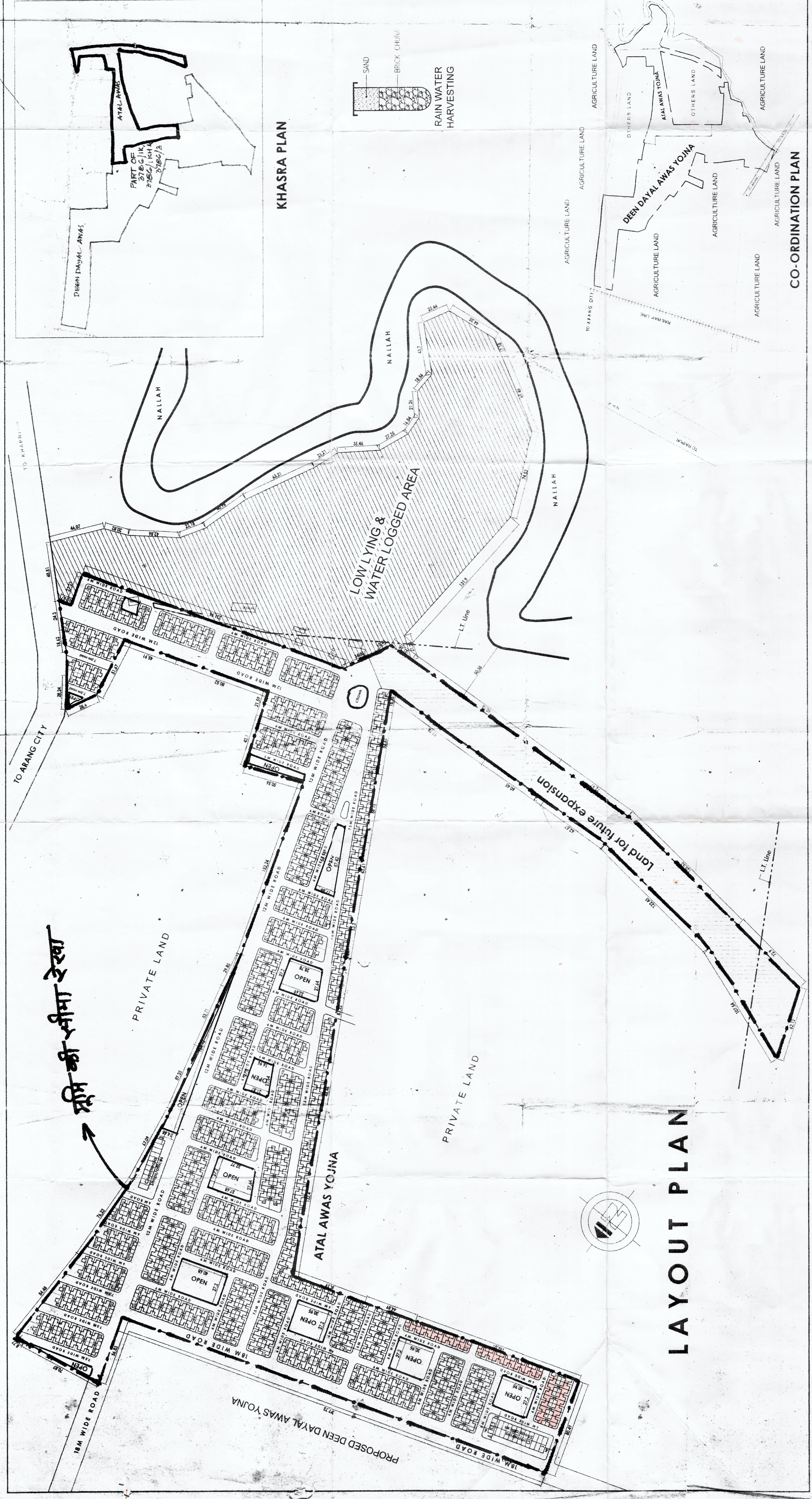

ग्राम की सीमा रेखा

LAYOUT PLAN

CO-ORDINATION PLAN