

राजि का राजा देवा

LAYOUT PLAN

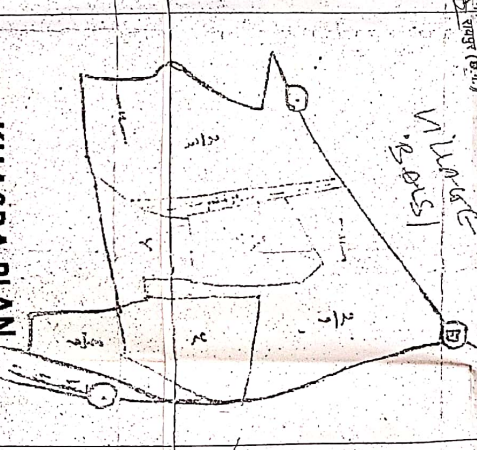
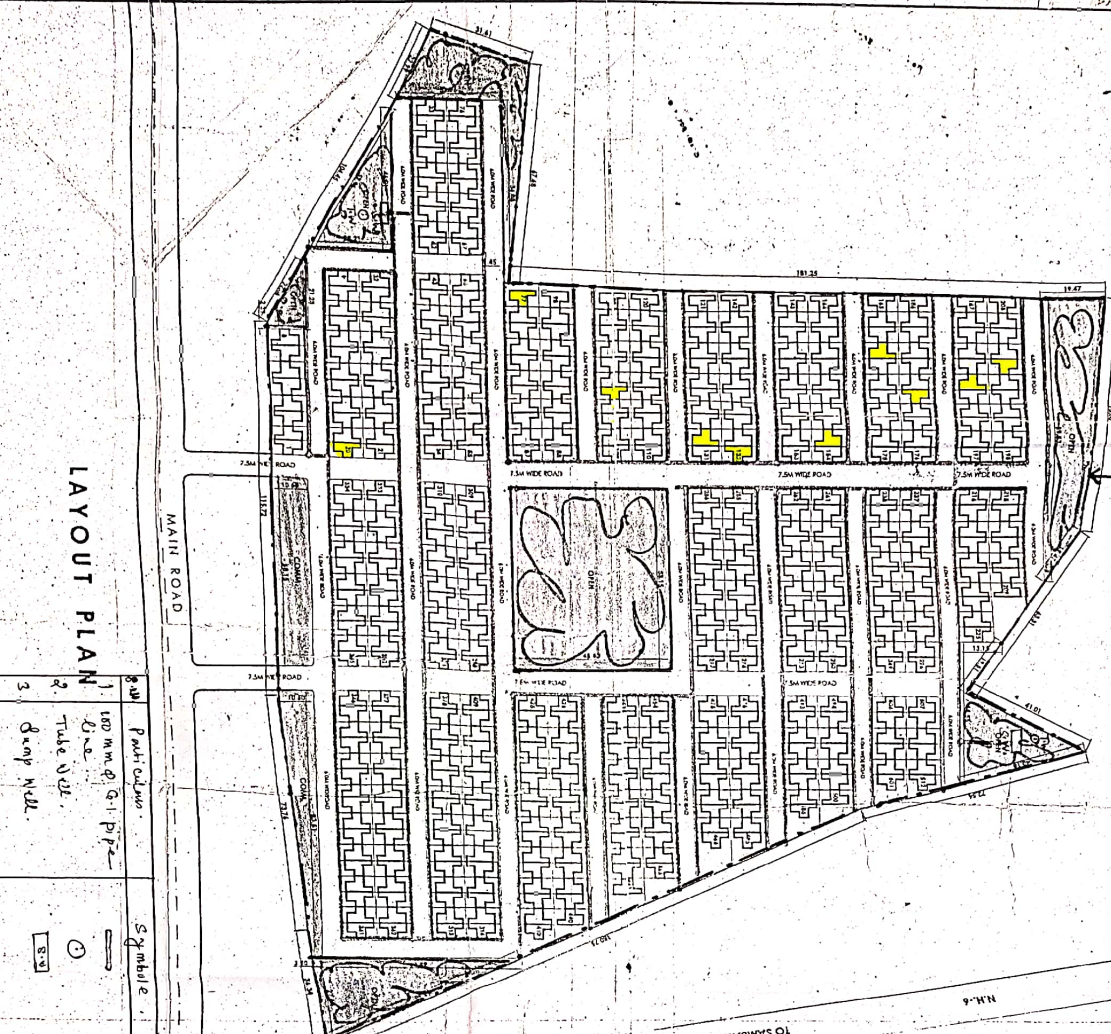

Valid up to 15-11-2019

APPROVED
राजि का राजा देवा
NATION PLAN

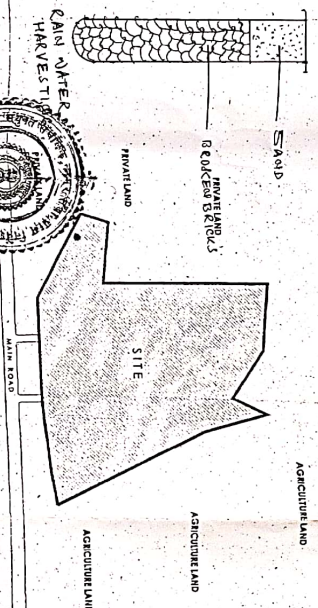

ATAL AWAS

PROJECT:
PROPOSED HOUSING LAYOUT OF
ATAL AWAS YOJANA FOR C.G.H.B. AT
KH.NO.2/1, 2/2, 2/3, 3, 4, 5
& 6/1, P.H.NO. 9, VILLAGE
SARAPALLI, R.N.MANDAL & TAH.
SARAPALLI & DIST. MAHASAMUND
(C.G.).

CLIENT:
CHHATTISGARH HOUSING BOARD

AREA STATEMENT

TOTAL LAND AREA 5.325 HECTARE
12.911 ACRES
OF 52267.85 SQM

PLANNING AREA ATAL AWAS 62267.85 SQM

ATAL AWAS YOJANA

LAND USE DETAILS	AREA IN SQM	PER.
RESIDENTIAL AREA	30637.26	58.62
COMMERCIAL AREA	1210.47	2.32
OPEN AREA	6138.83	11.74
ROAD AREA	14281.29	27.32
TOTAL	52267.85	100.00

NOOF PLOTS	PILOT SIZE IN METER	AREA IN SQM
512	10.60	4.95
	TOTAL	26321.92

S.NO	DATE
1.	
2.	

SUB. ENGINEER

ASST. ENGINEER

EXECUTING ENGINEER BOARD
CHHATTISGARH HOUSING BOARD
DR. RAJESH K. SHANMUGER

ARCHITECT

S. B. ARCH. M.C.A.
CA No 9417850

SHEETAL

CHK. BY

DRHUW

DRN. BY

DATE

03-07-2007

SCALE

1:1000

DEWAGAN & ASSOCIATES

ARCHITECTS/ENGINEERS/DESIGNERS/VALUERS

FIRST FLOOR, MOBIN MANSION, G.E. ROAD,
RAIPUR, CHHATTISGARH.

071 2234806

DRG. NO. SARAPALLI/AA/AY/01-1